

5.18 Schlüter®-BARA-RKB



EDGING PROFILE

WITH DRIP LIP FOR SURFACE COATINGS

Application and Function

Schlüter®-BARA-RKB is an edging profile for exposed edges of surface coverings on balconies and terraces with finished sloped screeds.

The exterior leg of the profile is shaped to form a protruding drip lip.

The trapezoid perforated anchoring leg of the finishing profile is fully embedded in the coating. Schlüter®-BARA-RKB provides a neat finish of the covering, protects the edge of the coating with its 3 mm front leg, shields exposed screed edges, and forms a protruding drip lip.

Material

Schlüter®-BARA-RKB is made of chromated, powder coated aluminium.

Material Properties and Areas of Application:

The coating on the aluminium profile is colour stable, as well as UV and weather resistant.

Visible surfaces should be protected against abrasion.

In special cases, the suitability of Schlüter®-BARA-RKB must be verified based on the anticipated chemical and mechanical stresses.

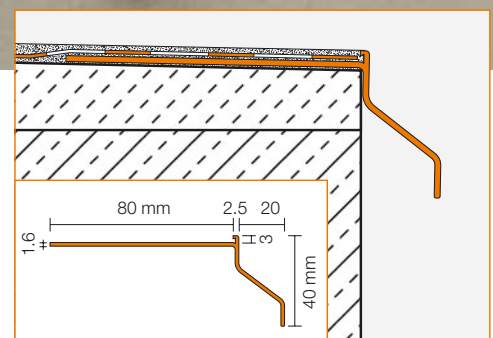

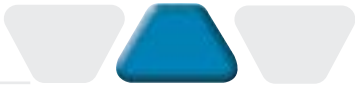

Installation

- 1. Apply a contact layer in the edge area where Schlüter®-BARA-RKB is to be installed.
- 2. The trapezoid perforated anchoring leg of Schlüter®-BARA-RKB is pressed into the contact layer and aligned.
If applicable, the profile has to be cleaned and degreased prior to installation.
- 3. Completely cover the trapezoid perforated anchoring leg with bonding material. The finished surface coating should be flush with the upper edge of the profile.

Note:
A crack bridging tape such as Schlüter®-KERDI-BAND may be integrated in the coating in the area of the profile.
Please note that the drip-lip cannot always prevent the contact of the drainage water with the front edge and the wall area.

Maintenance

Schlüter®-BARA-RKB requires no special maintenance. The aluminium profile's powder coated surface is UV resistant and colour-stable. Damaged visible surfaces can be restored with paint.

Product overview:

Schlüter®-BARA-RKB

Colour: PG = pastel grey, GM = grey metallic
Supplied length: 2.50 m

Colour	PG	GM
Profile	•	•
90° corner	•	•
135° corner	•	•
90° inside corner	•	•
Connector	•	•

Text template for tenders:

_____ linear metres of Schlüter®-BARA-RKB as a T-shaped finishing profile made of powder coated aluminium with integrated protruding drip lip, to be supplied and professionally installed while observing the manufacturer's instructions by properly embedding the trapezoid perforated anchoring leg into the coating. Accessories such as inside and outside corners and connectors

☐ are to be included in the unit prices.
☐ are to be charged separately.

Colour: _____
Art.-No.: _____
Material: _____/m
Labour: _____/m
Total: _____/m

